

# AC HOTEL BELLA SKY COPENHAGEN FLOOR PLAN & CAPACITY CHART

## MEETING FACILITIES 1<sup>ST</sup> FLOOR

LOCATION		CAPACITY Incl. 4 in panel	DIMENSIONS & SIZE		SET-UP							
Loc.	No.	Max	L/W/H	m <sup>2</sup>	Theatre	Classroom	U-shape	Square	Boardroom	Banquet Ø150/180	Cabaret Ø150/180	Restaurant
BCC	5	93	12/9/2.7	108	93	50	34	44	28	64	48	
BCC	6	65	9/9/2.7	81	65	30	24	32	20	48	36	
BCC	05-06	166	-/-2.7	189	166	98		32		128	96	
BCC	7	39	9/6/2.7	65	39	20	16	24		32	24	
BCC	06-07	124	-/-2.7	146	124	62		46		88	72	
BCC	05-07	232	-/-2.7	254	232	124				168	138	
BCC	16	46	8.9/6.1/2.9	54	46	32	22	28		40	24	
BCC	17	46	9/9/2.9	81	46	46	26	36		48	36	
BCC	18A	8*	5/3.5/2.9	18					8			
BCC	18B	8*	5/3.5/2.9	18					8			
BCC	18	97	12/9/3.6	108	97	54	28	36		64	48	
BCC	19	119	13/9/3.6	117	119	56	34	44		64	48	
BCC	18-19	194	13/18/3.6	234	194	100	58	60		136	108	
BCC	20	126	14/9/3.7	126	126	66	38	48		64	48	
BCC	21	18	8.5/5.8/3.3	49					18			
BCC	22	14*	7/5/3.1	35					14			
BCC	23	12	5.5/5.2/2.5-2.9	25					12			
BCC	24	10*	7/4/2.5-2.9	28					10			
BCC	25	10*	7/4/2.7	28					10			
T1	137	9*	5.3/3.7/4.2	20					9			
T1	138	9*	5.3/3.7/4.2	20					9			
T1	137-138	13	5.6/7.5/4.2	42					13			
T1	139	13*	5.6/7.5/4.2	32					13			
T1	140 VIP	13*	5.8/6.4/4.2	37					13			
T2	170	8*	5.8/4.7/3.7	25					8			
T2	171 VIP	13*	5.8/7.3/3.7	42					13			
T2	172 VIP	13*	5.8/6.4/4.2	37					13			
T2	173	98	9/10.4/3.7	94	98	48	26	30		64	48	
T2	174	20	6.7/3.7/3.7	23	20				9			
T2	175	20	5.7/3.8/3.7	23	20				9			
T2	174-175	44	5.7/7.5/3.7	50	44	12	10	16	10			
T2	176	9*	6.7/3.7/3.7	23					9			
T2	177	9*	5.7/3.8/3.7	21					9			
T2	176-177	18	5.7/7.5/3.7	50			14		14			
T2	178	57	8.3/7.5/3.7	62	55	24	18		16	40	30	
T2	179	55	9.3/7.5/3.7	70	55	24	18		16	40	30	
T2	180 Ballroom	91	10.8/10.7/3.7	117	91	48	26			56	48	
T2	181 Ballroom	120	10.7/14.6/3.7	158	120	60	38			70	60	
T2	180-181 Ball.	288	14.6/21.6/3.7	325	288	160	62			196	168	

\*excl. panel  
(non standard set-up)

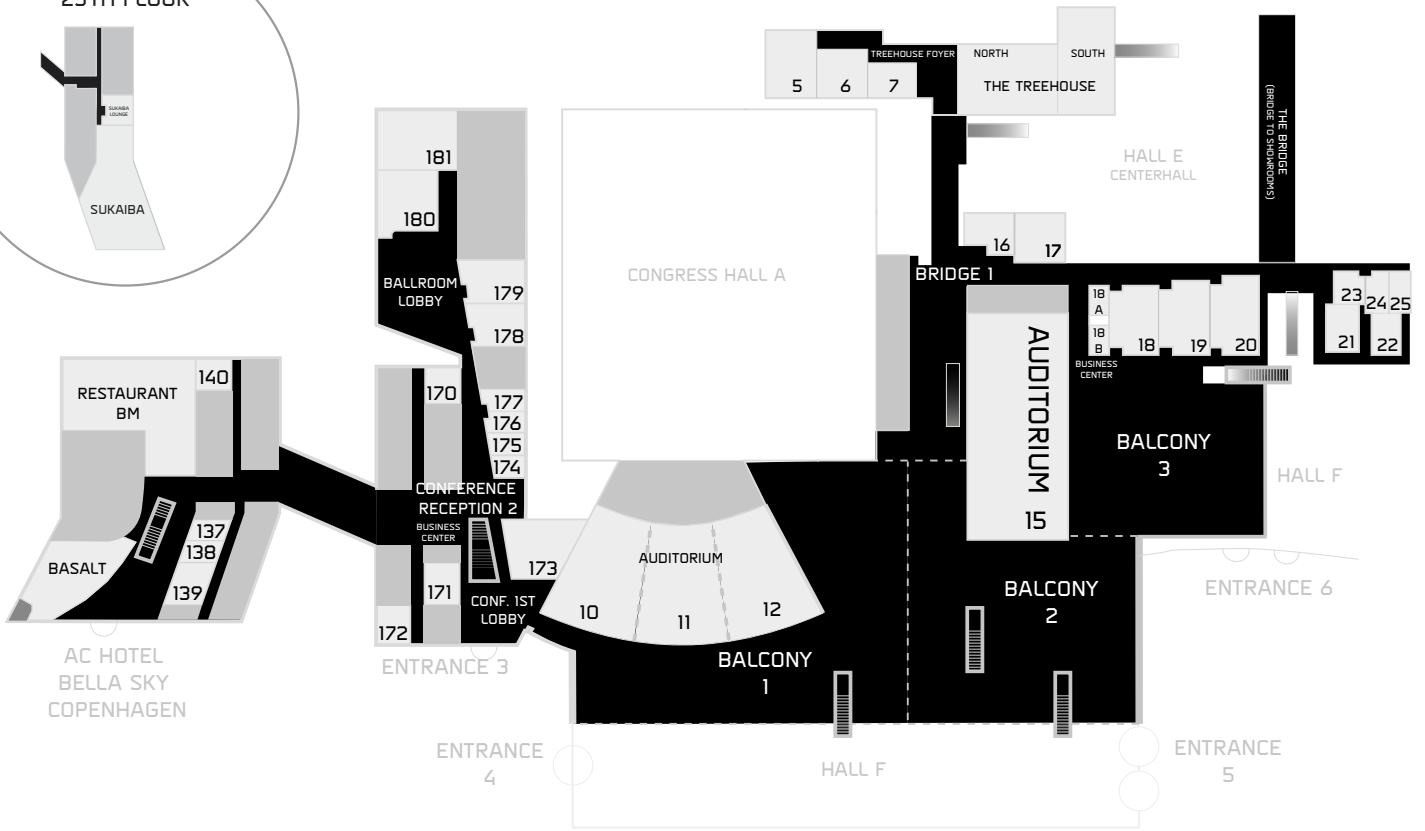

## RESTAURANTS

Loc.	Floor	Hall	Name	Function	Capacity (seated)*
T1	Ground	Lobby	Lobby Bar	Restaurant/Bar	61
T1	Ground		Library Restaurant	Restaurant/Bar	60
T1	1st		BASALT	Restaurant/Bar	75
T1	1st		BM Restaurant	Restaurant	240
T2	23rd		SUKAIBA	Restaurant/Bar	181
BCC	Ground	Hall E/Main lobby	The Gastro	Restaurant	138
BCC	Ground	C1	Orangu Lounge	Café	109
BCC	1st		The Treehouse	Restaurant	234
BCC	1st		The Treehouse North	Restaurant	124
BCC	1st		The Treehouse South	Restaurant	114

\*Based on standard set up.

## AUDITORIUMS 1<sup>ST</sup> FLOOR

LOCATION		CAPACITY	DIMENSIONS & SIZE		SET-UP
Loc.	No.	Max	L/W/H	m <sup>2</sup>	Theatre
BCC	10	310	26/10-18/7.7	395	310
BCC	11	310	26/10-18/7.7	395	310
BCC	12	310	26/10-18/7.7	395	310
BCC	10-11	620	26/10-36/7.7	790	620
BCC	11-12	620	26/10-36/7.7	790	620
BCC	10-12	930	26/10-54/7.7	1,185	930
BCC	15-1	362	40/18/9.5	720	1-362
BCC	15-2	582	40/18/9.5	720	363-582

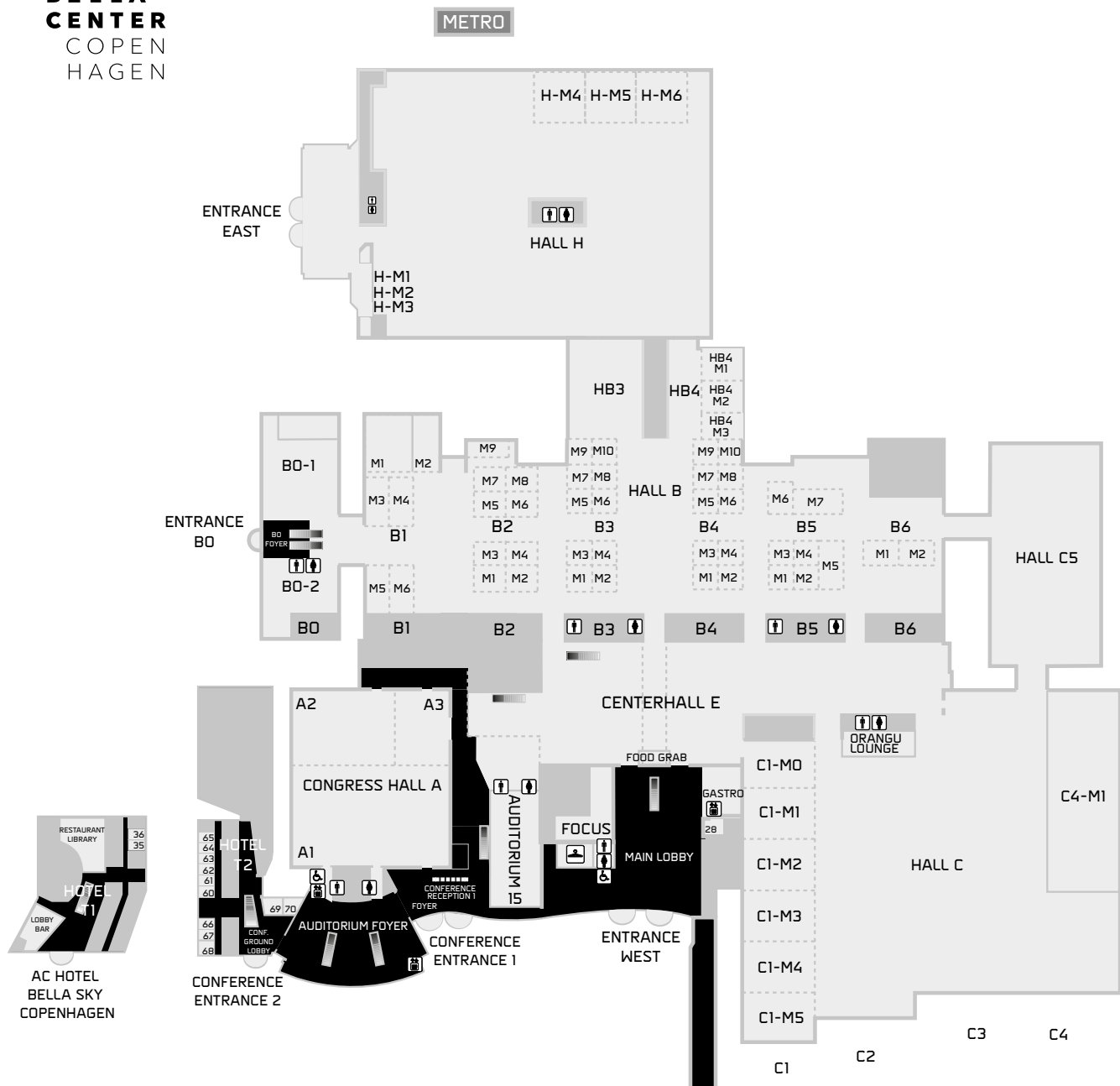

**MEETING FACILITIES GROUND FLOOR**

LOCATION		CAPACITY	DIMENSIONS & SIZE		SET-UP			
Loc.	No.	Max	L/W/H	m <sup>2</sup>	Theatre	Classroom	U-shape	Boardroom
T1	35	8	4.7/3.6/4	17				8
T1	36	8	4.7/3.6/4	17				8
T1	35+36		4.7/7.2/4	35	34	12	14	
T2	60	9	5/3.7/4.2	19				9
T2	61	9	5/3.7/4.2	19				9
T2	60-61	10	5/7.5/4.2	38	(38)	8	10	10
T2	62	9	5/3.7/4.2	19				9
T2	63	9	5/3.7/4.2	19				9
T2	62-63	10	5/7.5/4.2	37	(38)	8	10	10
T2	64	9	5/3.7/4.2	19				9
T2	65	9	5/3.7/4.2	18				9
T2	64-65	10	5/7.5/4.2	37	(38)	8	10	10
T2	66	9	5/3.7/4.2	19				9
T2	67	9	5/3.7/4.2	19				9
T2	66-67	10	5/7.5/4.2	37	(38)	8	10	10
T2	68 VIP	6	5/2.9/4.2	15				6
T2	69	14	5/5.4/4.2	26	(27)		14	8
T2	70	12	5/5.1/4.2	26	(22)		12	8
T2	69-70	42	10/5.1/4.2	51	42	22	18	14
BCC	28	8	4.1/2.7/2.5	11				8

(non standard set-up)

## MEETING FACILITIES GROUND FLOOR

LOCATION		CAPACITY	DIMENSIONS & SIZE		SET-UP				
Loc.	No.	Max	L/W/H	m <sup>2</sup>	Theatre	Classroom	Banquet	Cabaret	U - Shape
<b>CONGRESS HALL A</b>									
BCC	A1	2,295	56/36/2.5-9	2,000	2,295	1,035	1,088	840	
BCC	A2	1,146	37/27/2.5-9	1,000	1,146	420	800	408	
BCC	A3	560	19/27/2.5-9	500	560	180	360	234	
BCC	A2-A3	1,762	56/27/2.5-9	1,500	1,762	762	832	648	
BCC	A1-A3	4,326	56/63/2.5-9	3,500	4,326	1,835	2,800	1,608	

<b>MEETING ROOMS IN HALL B</b>									
BCC	B1 M1	218	17.9/18.1/3.3	292	218	138	216	150	60
BCC	B1 M2	48	8.9/18.1/3.3	164	48	30	48	36	26
BCC	B3 M1/2/3/4/5/6/7/8/9/10	65	9/9/3.2	81	65	30	48	36	26
BCC	B3 M1-2/M3-4/M5-6/M7-8/M9-10	169	18/9/3.2	162	169	90	136	90	52
BCC	B3 M1-4/M5-8	312	18/18/3.2	324	312	160	240	156	62
BCC	B3 M5-10	546	27/18/3.2	486	546	280	284	264	90
BCC	B4 M1/2/3/4/5/6/7/8/9/10	65	9/9/3.2	81	65	30	48	36	26
BCC	B4 M1-2/M3-4/M5-6/M7-8/M9-10	169	18/9/3.2	162	169	90	136	90	52
BCC	B4 M1-4/M5-8	312	18/18/3.2	324	312	160	240	156	62
BCC	B4 M5-10	546	27/18/3.2	486	546	280	384	264	90
BCC	B5 M1/M2/M3/M4	65	9/9/3.2	81	65	30	48	36	26
BCC	B5 M1-2/M3-4	169	18/9/3.2	162	169	90	136	90	52
BCC	B5 M1-4	312	18/18/3.2	324	312	160	240	156	62

<b>MEETING ROOMS IN HALL HB</b>									
BCC	HB4 M1	150	15/12/3.3	180	150	84	128	84	
BCC	HB4 M2	190	15/12/3.3	180	190	98	128	84	
BCC	HB4 M1-M2	380	15/24/3.3	360	380	196	256	186	

<b>MEETING ROOMS IN HALL C</b>									
BCC	C1 M0	392	22.4/18/4.4	420	366	166	280	204	
BCC	C1 M1/M2/M3/M4/M5	420	26/18/4.4	468	420	188	280	228	
BCC	C4 M1	2,210	72/27.4/8.15	1,944	2,120	990	1,200	978	

<b>MEETING ROOM IN HALL C5</b>									
BCC	C5	2,700	80/40/6.35	3,200	2,700	1,320	1,776	1,404	

<b>MEETING ROOM IN CENTER HALL E</b>									
BCC	Focus	150		375					

<b>MEETING ROOMS IN HALL H</b>									
BCC	H M1	30	15/4/2.2	60	30				
BCC	H M2/M3	15	5/4/2.5	20	15				
BCC	H M4/M5/M6	312	18/18/4.6	324	312	140			
BCC	H M4 M5/M5 M6	725	-/-/4.6	684	725	340			
BCC	H M4 M6	1,100	-/-/4.6	1,026	1,100	540			

## HALLS

Loc.	No.	L/W/H (flexible)	m <sup>2</sup>
<b>CONGRESS HALL A</b>			
BCC	A1	56/36/2.5-9	2,000
BCC	A2	37/27/2.5-9	1,000
BCC	A3	19/27/2.5-9	500
BCC	A2-A3	56/27/2.5-9	1,500
BCC	A1-A3	56/63/2.5-9	3,500

<b>HALL B</b>			
BCC	B0 1	-/27/3.2	1,077
BCC	B0 2	-/27/3.2	735
BCC	B1	53.9/27/3.3	1,330
BCC	Light arcade between B1-B2	36/9/9	594
BCC	B2	54/27/2.5	1,624
BCC	Light arcade between B2-B3	36/9/9	567
BCC	B3	63/27/2.5-3.3	1,701
BCC	Light arcade between B3-B4	36/9/9	567
BCC	B4	63/27/2.5-3.3	1,701
BCC	Light arcade between B4-B5	36/9/9	567
BCC	B5	54/27/2.5	1,512
BCC	Light arcade between B5-B6	36/9/9	594
BCC	B6	63/27/2.5-3.3	1,110
BCC	B0-B6	-/-/2.5-9	13,679

<b>HALL HB</b>			
BCC	HB3	36/27/3.3	972
BCC	HB4	32-36/27/3.3	927

<b>HALL C</b>			
BCC	C1	108/26-27/4.3	2,916
BCC	Light arcade between C1-C2	99/9/6.2	891
BCC	C2	103/27/6.55	2,592
BCC	Light arcade between C2-C3	99/9/7.7	891
BCC	C3	108/27/8.05	2,916
BCC	Light arcade between C3-C4	108/9/7.7	972
BCC	C4	108/27/8.15	2,835
BCC	C1-C4	-/-/4.4-8.25	14,013

<b>EAST HALL H</b>			
BCC	H	121/93/4 6	10,900

## FOYERS

Loc.	No.	L/W/H (flexible)	m <sup>2</sup>
BCC	B0	-/27/3.2	185
BCC	East Hall	42/18/4.4	756
BCC	Auditorium	54/25/3.9	1,202
BCC	Congress	15-36/63/3-10	1,667
BCC	Aud. Balcony	-	339
BCC	The Terrace	21/20/5.5-7.5	365
BCC	Main Lobby	-	2,120
T2	Ballroom Lobby		207
T2	Conf. Reception 1		148



The Treehouse



Conference Room 140



Conference Reception



Auditorium 10-12





Center Hall E South



Auditorium Foyer



Hotel Lobby



Center Boulevard 5  
DK-2300 Copenhagen S  
T +45 3247 3000  
F +45 3247 3001  
E [hotel@bellasky.dk](mailto:hotel@bellasky.dk)  
W [acbellaskycopenhagen.com](http://acbellaskycopenhagen.com)