

# LEEDS ROOM GROUND FLOOR

CALLE DEL INGENIERO CONDE DE TORROJA

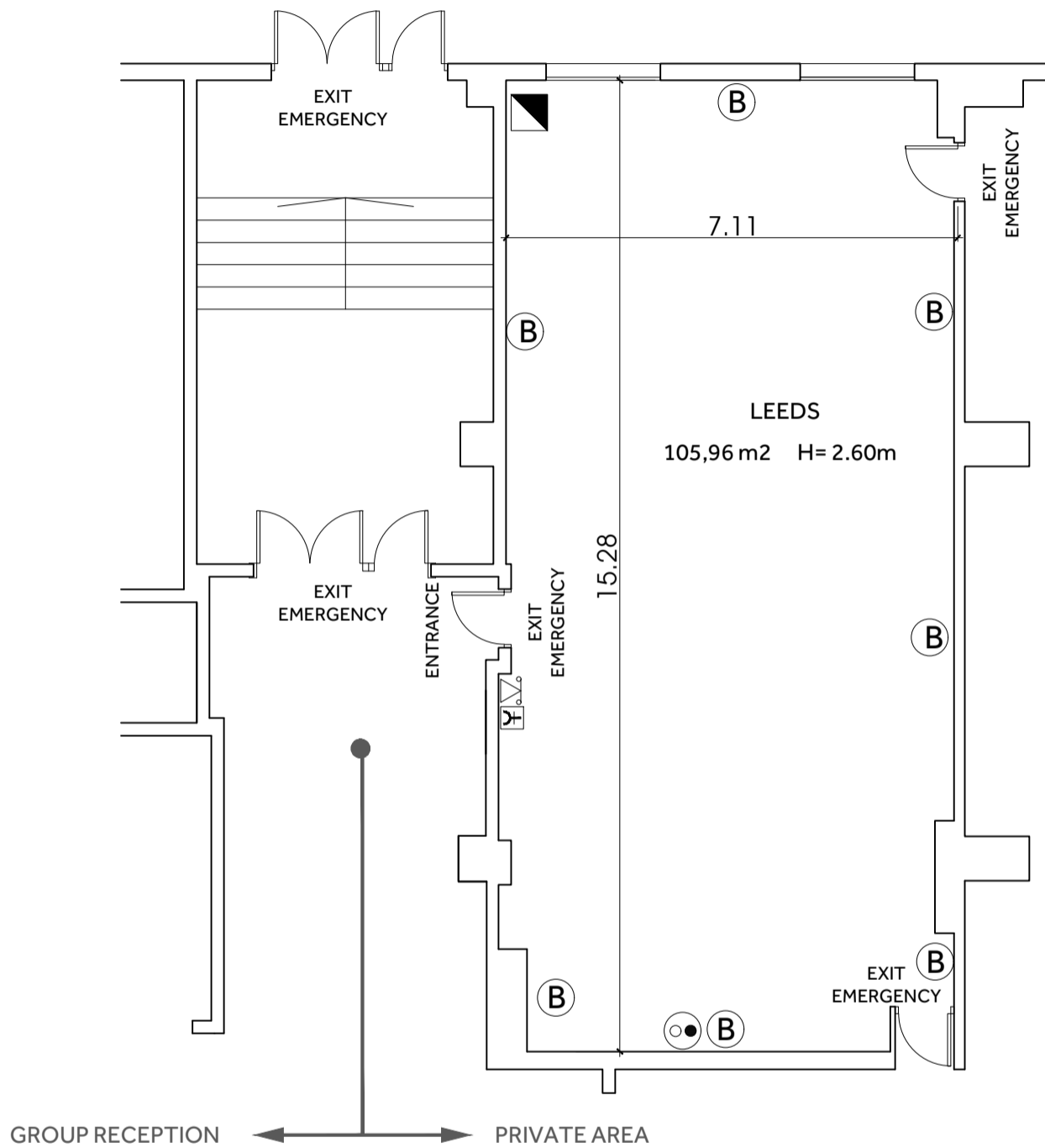

#### ELECTRICITY AND TELECOMMUNICATIONS LEGEND

	<ul style="list-style-type: none"> <li>1 Three-phase current 63A</li> <li>1 Three-phase current 32 A</li> <li>1 Single phase electrical supply 32 A</li> <li>2 Singles phase electrical supply 16 A</li> </ul>
	<ul style="list-style-type: none"> <li>6 socket 220V 16 A</li> <li>4 RJ 45 sockets</li> </ul>
	TV and FM point
	Phone point