



JW Marriott Parq Vancouver

39 Smithe Street, Vancouver, British Columbia V6B 0R3 Canada
Phone 604.566.8808 jwmarriottparqvancouver.com

Rising against a backdrop of majestic coastal mountains on Canada's pristine Pacific coast, the JW Marriott® Parq Vancouver unveils a quintessential meeting destination—built for LEED® Gold Certification—in the heart of downtown Vancouver's vibrant entertainment district. More than 60,000 square feet of indoor and outdoor urban event space is complemented by authentic experiences like Chef on Show culinary presentations, flexible event lounges and grand spaces that entertain open exchange and productivity, opening your group up to new ideas and replenished spirits.

Location

Located within Parq Vancouver, the focal point of the city's energetic downtown entertainment district, where guests enjoy instant access to a breadth of amenities, including eight restaurants & lounges, an elevated sixth floor park and world-class gaming • Walkable to iconic Vancouver neighborhoods like Gastown and Yaletown, in addition to BC Place

Accommodations

Designed by acclaimed Studio Munge, known for sumptuous, luxurious residential design • 329 exquisite guest rooms, including 44 suites, 3 luxury suites and a striking two-floor villa • Amenity-laden to accommodate the needs of both the business and leisure traveler • Groups can also enjoy access to 188 additional rooms and suites within Parq Vancouver at the DOUGLAS, an Autograph Collection® hotel

Restaurants & Lounges

A smart location within the cultural hub of Parq Vancouver allows guests effortless access to eight world-class restaurants & lounges led by James Beard Award—nominated masterminds Elizabeth Blau and her husband, Chef Kim Canteenwalla.



Meetings Enriched
by a Natural Brilliance

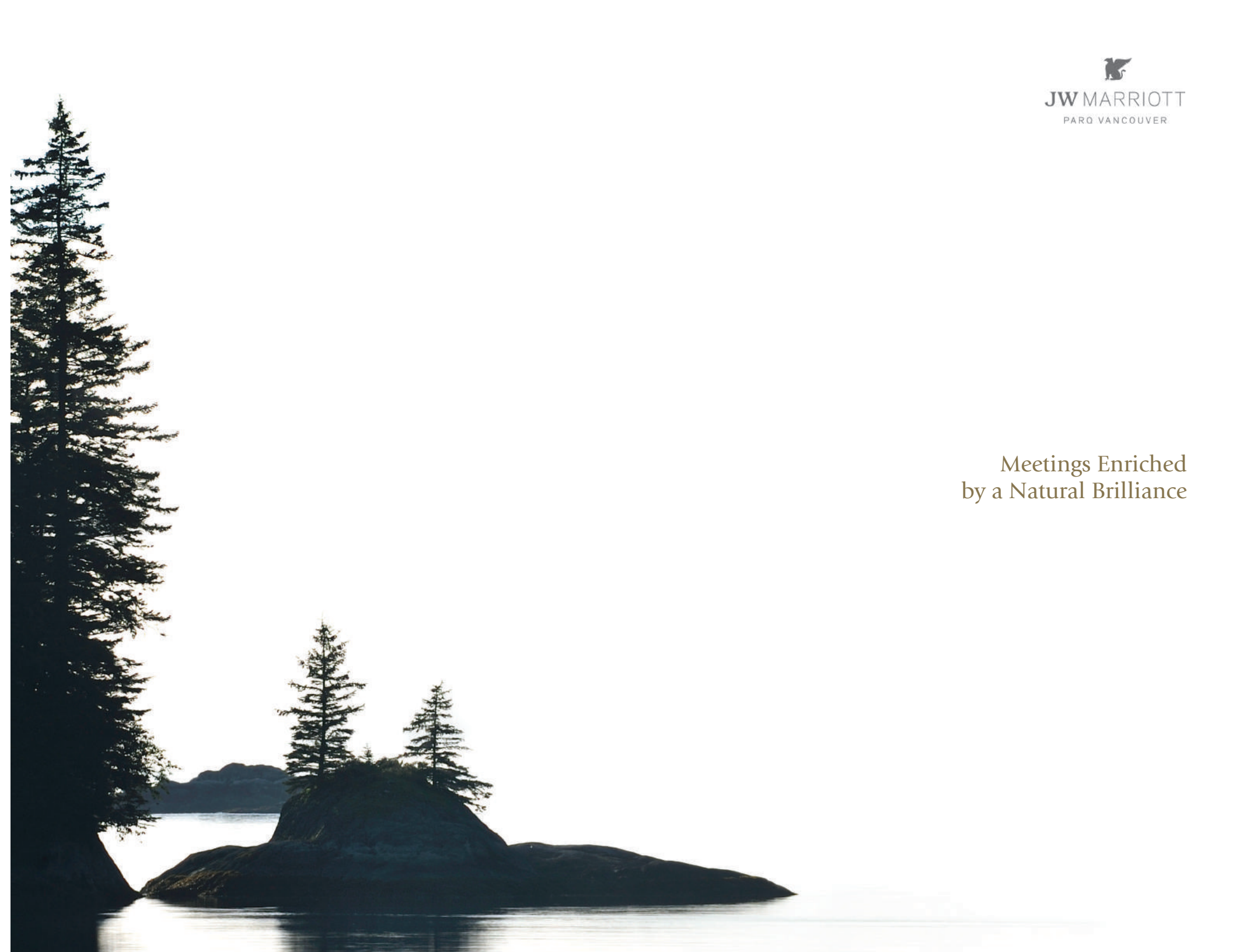

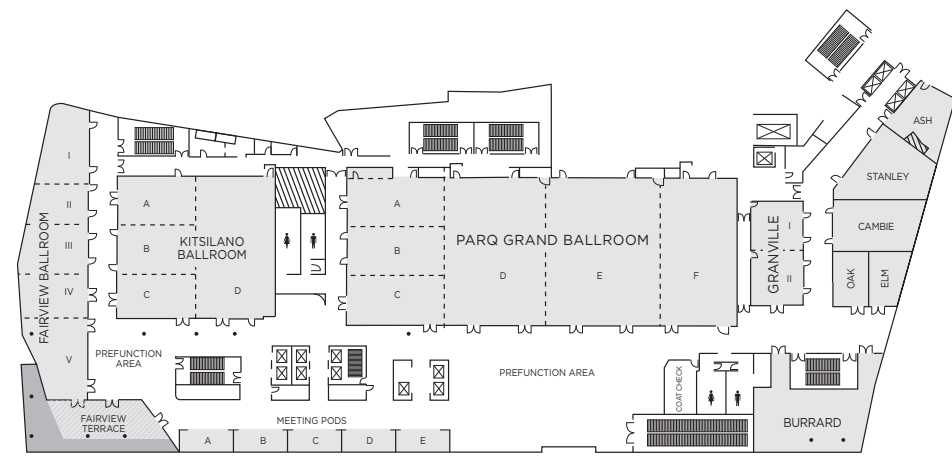

Meeting Space Highlights

- A contemporary hotel inspired by its natural surroundings and crafted for LEED Gold Certification
- 60,000 square feet of flexible function space, all conveniently located on one level
- 15,604-sq-ft Parq Grand Ballroom, Vancouver's largest, features 23-foot ceilings and accommodates 1,144 guests
- Two additional ballrooms offer flexibility to accommodate smaller events
- 30,000-sq-ft rooftop greenspace with capability for outdoor dining
- 22 breakout rooms with floor-to-ceiling views and state-of-the-art audio-visual technology
- Wired and wireless Internet access
- Events by JW – creating extraordinary events led by Chefs on Show culinary presentations

	DIMENSIONS		CAPACITY							
	LxWxH	Sq Ft	Classroom	Conference	Theatre	Banquet	Reception	8x10 Booth	10x10 Booth	U-Shape
Parq Grand Ballroom	77'x203'x23'	15,604	936	–	1,144	1,144	1,144	95	82	–
Salon A	26'x48'x23'	1,235	72	36	91	91	91	8	–	36
Salon B	26'x48'x23'	1,228	60	36	60	60	60	8	–	36
Salon C	26'x48'x23'	1,233	72	36	90	90	90	7	–	36
Salon D	54'x76'x23'	4,105	252	–	306	306	306	26	19	87
Salon E	54'x76'x23'	4,109	252	–	314	314	314	26	19	87
Salon F	48'x77'x23'	3,689	216	–	270	270	270	26	19	70
Parq Grand Ballroom Prefunction		6,300	–	–	–	–	630	35	35	–
Kitsilano Ballroom	80'x74'x18'	5,909	324	–	423	420	423	33	26	–
Salon A	23'x40'x18'	926	54	30	70	60	70	6	3	30
Salon B	27'x40'x18'	1,099	54	30	60	60	60	6	6	30
Salon C	23'x40'x18'	926	54	30	69	69	70	5	3	30
Salon D	74'x40'x18'	2,950	162	60	224	224	224	17	13	60
Kitsilano Ballroom Prefunction		2,500	–	–	–	–	250	6	6	–

	LxWxH	Sq Ft	Classroom	Conference	Theatre	Banquet	Reception	8x10 Booth	10x10 Booth	U-Shape
Fairview Ballroom	–	4,456	–	138	325	280	325	14	14	–
I	32'x22'x18'	700	36	20	50	50	50	–	3	20
II	28'x28'x18'	786	36	24	57	50	57	–	4	24
III	28'x34'x18'	947	48	27	69	50	69	–	5	27
IV	22'x35'x18'	786	36	24	56	50	56	–	3	24
V	28'x45'x18'	1,237	66	32	91	80	91	–	4	32
Fairview Terrace		976	–	–	–	120	98	–	–	–
Granville	32'x26'x10'	1,638	72	40	127	100	127	–	–	40
I	32'x26'x10.5'	832	42	20	64	50	64	–	–	20
II	32'x25'x10.5'	806	42	20	63	50	63	–	–	20
Stanley	24'x42'x10.5'	1,087	54	27	80	60	80	–	–	27
Cambie	25'x43'x10.5'	1,065	54	27	80	60	80	–	–	27
Burrard	32'x55'x10.5'	1,760	75	40	160	120	160	–	–	40
Ash Boardroom	18'x29'x10'	581	–	12	–	–	–	–	–	–
Oak Boardroom	29'x16'x10'	472	–	12	–	–	–	–	–	–
Elm Boardroom	26'x17'x10'	430	–	12	–	–	–	–	–	–